

Preface

It was 11 years ago when Lintech established to meet customer requirement on low service cost at International quality of steel fabrication and rubber works for Mining and Oil Gas Industry. During the 11 years of journey into a mature ISO company, we have been helped by so many partners and friends as customers as long as suppliers, locally Indonesia and overseas. Lintech always maintain our project with worldclass standards and hold it tight in the progress with our eastern politeness heart.

In this moment, We would like to express our appreciation to our customers for the good trust and cooperation to Lintech's management and quality system. Wish we can extend this cooperation into bright year 2010. Wishing you all the best.

Lintech to Complete 4(Four) -50 (fifty) Tonnes for LPG Storage of Refilling Station (SPBE)

Further to approval of ASME U Stamp, Lintech started to work on LPG Storage tank, both for static and transport use. The material is using 500Mpa Yield Strength Plate. All materials are locally Indonesian available and manufactured 100% inhouse Lintech Shop in Surabaya. All size to meet Pertamina standard (Indonesian Oil&gas Company) are available at Lintech for your best LPG/CNG infrastructure investment.



Deliver 50 Tons LPG Static Storage tank



Manufacturing 50 Tons Static Storage Tank



Manufacturing 15 Tons Land Transport Tank

Lintech Completes Fluid Bed Cooler for BECHTEL – Western Australia Project

In this December 2009, Lintech will deliver Fluid Bed Cooler for West Australia final destination. It is manufactured to FLSMIDTH Design and specification and certified by LINTECH's international recognition ASME U STAMP. It should justify Lintech to involve in your project, local Indonesia or overseas for quality and cost. Following are the equipment summary:

Fluid Bed Cooler :

Client: FLSmidth

Owner: Bechtel

Dimension: Height= 5800mm ; Diameter = 5760mm

Tonnage: +/- 60 tones

Function: Cooler tank to process the Alumina liquid to produce aluminum

Capacity: 26 KL

Material Specification: AS3678 Grade 350

(substitution S355JR, SM490YB and ASTM-A-572 grade 50) & A179 (for tubes)

Welding: Use GTAW and SMAW

Manufacturing Process: rolled & PWHT
(for A179 tubing).

Standard: Australian standard (ASME div 8
approached references)



Petroorganik with C organik content 12,5%; C-N Ratio 25%. With Lintech's special dryer's burner design, the capacity of the plant can be improved to more 50% capacity. Along with this success, Lintech will fill the investor requirement for complete organic fertilizer plant, start from design up to commissioning and help Indonesia Government to meet cheap fertilizer for farmers and sustain food production.



Bagging and Product Storage

One of Lintech's company start produce Organic Fertilizer

It was decided by shareholder last year that sometime Lintech need to make its own processing plant after so many plant we have built in the past. With Indonesia Government policy for reducing of Chemical fertilizer consumption and switched to Organic Fertilizer in rice and other plantation, in this month Lintech can see the fertilizer start produced by Lintech's constructed plant in Mojokerto – East Java. The plant is designed to produce 1200kg/hour of



LINTECH SECURED Monsanto's Corn Seed Processing Plant Electrical & Control System Package

After completes the PIONEER-DUPONT Rice and Corn Plant, the typical plant invested by PT.Branita-MONSANTO in Mojokerto also to be mainly constructed by Lintech.

It was electrical and control system engineering works completed by Lintech for Monsanto before the electrical package going to bid.

The scope of works for the plant electrical system to cover supply and install MDP, wiring , control panels and PLC Plant Control System programming.

“Competing with Schneider in this Monsanto's project is a good exercise for Lintech's electrical division team. It will be completed by Lintech on quality and on time as usual”

Now, Lintech proven to be an option to investors/customers and maincontractors in Indonesia and Overseas to use Lintech's services for the electrical and control system package along with the civil work and steel fabrication for their infrastructure construction.

In Lintech, we do 90% of Investor's project ourself, while the 10% can be done by our subcont and consultant (not in viseversa) for cost, quality and schedule efficiency. It the era when investors/customers want the contractor minimizing subcontract to keep investment cost as low as possible, Lintech is the most suitable partner.

Congratulation to Lintech's electrical division by winning this package. Well Done and Good Luck.

LINTECH Expand Steel Structure Design and Fabrication Capabilities and Capacities

Recently Lintech's engineering division utilizing SAP, TEKLA and Autocad for Design and detailing steel for shop fabrication purpose. Along with more customer different requirement, Lintech investing new software from BENTLEY for 3D modelling and stress analysis up to Shop Detailing. The package consist of STAAD Foundation for civil foundation design, PROSTEEL V8i for Structural Steel Detailing and Fabrication, RAM Connection V8i for Steel Connection Design, STAAD Pro V8i for Structural design stress analysis.

Now Lintech's engineer can design complete plant structure or building structure inhouse completely or we can receive a 3D design drawings from customer and turn it into shop detail in just a day or hours.

To support Lintech's capability in steel design engineering, Lintech also investing in Welded Beam production line to produce up to 600 ton of weldedbeam/month. This beamline is to be installed at our new 3000sqm steel shop (as subsidiary to our existing 10,000sqm Surabaya's shop) on the 220,000sqm yard in LSF (www.lsf.co.id) in adjacent of our other machinnery equipment for steel manufacturing for Tank, Offshore platform and Structure, Pressure Vessel, Pipeline, etc.

In 2010, Lintech is ready to deliver and compete with our competitors in Asia for low Price at worldclass Quality.

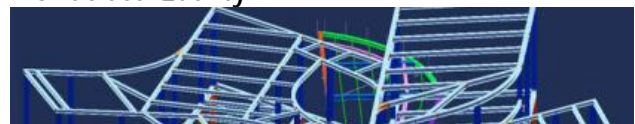



Oil & Gas, Marine, Mining & Industrial Engineering - Fabrication – Construction
Lintech Newsletter, December 2009 Special Edition- ***Celebrating Lintech's 11 years***

For your project inquiries, please contact:

PT. LINTECH DUTA PRATAMA

Jl. Raya Mastrip 70 - Wirajatim Industrial Estate -
Karang Pilang
Surabaya, Indonesia

Website: www.lintech.co.id; www.LSF.co.id

Email: admin@lintech.co.id